

I _x	19.35 cm ⁴
W _x	7.04 cm ³
I _y	19.37 cm ⁴
W _y	7.04 cm ³

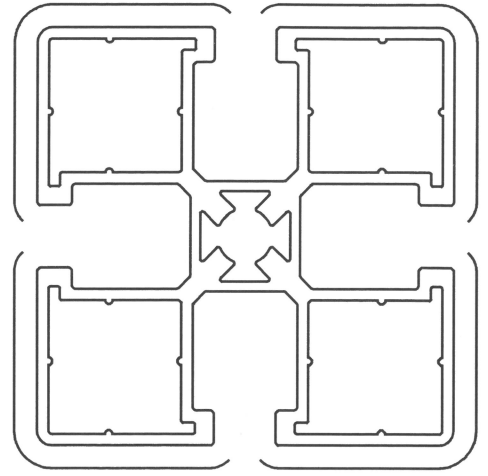

1:1

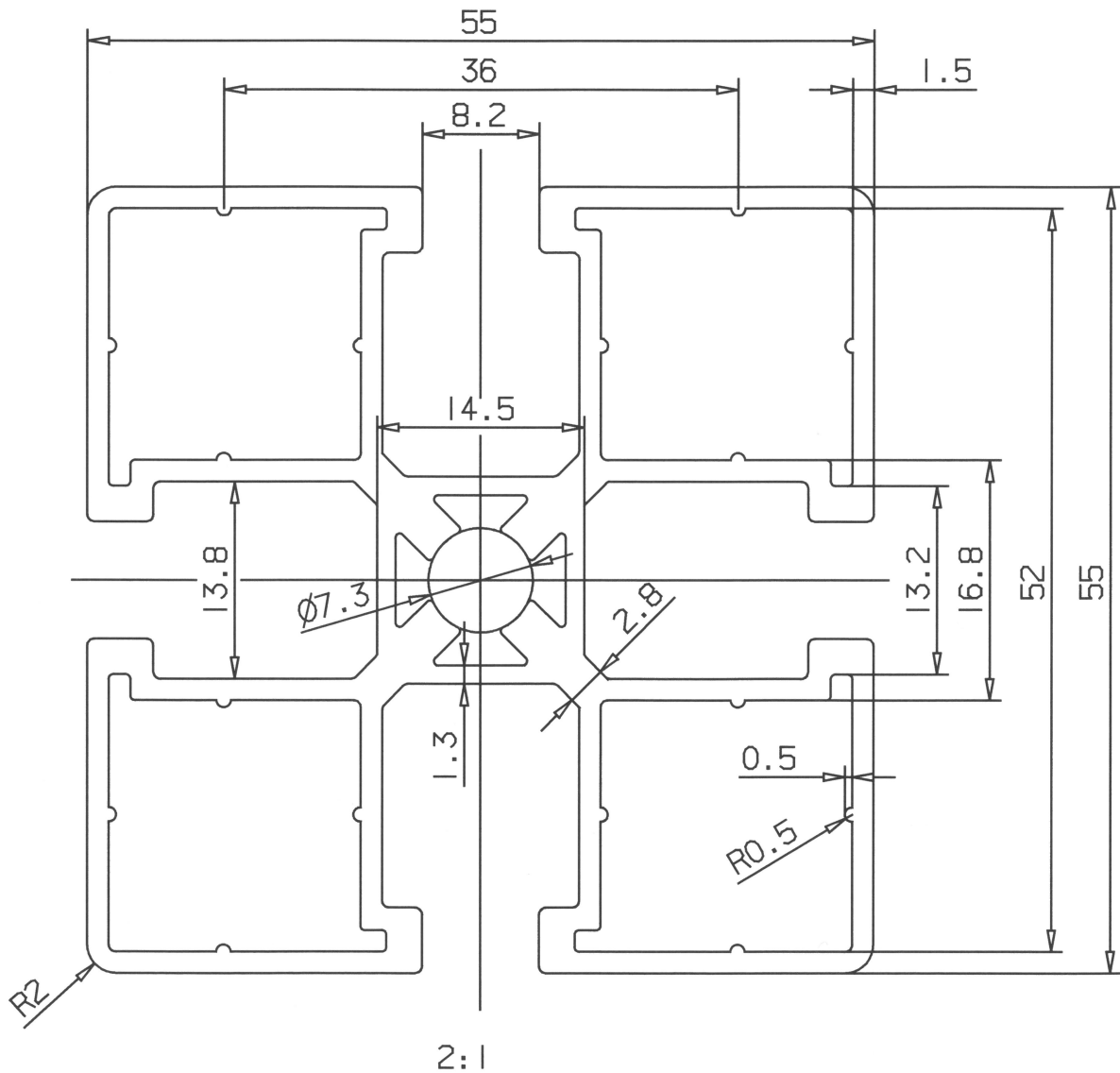

FULL RAD		●R0.3	+ R1.0	Primary surface	Secondary surface	Not visible surface	Identification area
S C	Ref.	Visib. surf.	YES	Net. P.m.	Customer nr:		
Ø.c.a.s.	76	Kg/m	1.823	Gen. thickn.	1.5	Gen. Rad.	0.5
P.m.	410	Alloy	AW-6063 T6	Straightn.	EN 755-9	Insp.	
S.a.	675	Toler.	EN 755-9	Flatness	EN 755-9	Acc.	
Surf.gateg.	ZNE	Anod.	YES	Identif.	NO	T-no.	
				Torsion	EN 755-9	No.	